

AGROSAL d.o.o.

BCS

622



AGROSAL d.o.o.

*Gregorčičeva ulica 38, 5270 Ajdovščina
telefon: 05 368 90 96, fax: 05 368 90 97
e-mail: info@agrosal.si, www.agrosal.si*

BCS

622



* 331.12530 RIBATTINO

* 522.02303 MANICOTTO

C.208. 8. 20 -- 311.11152. VITE

5 — 561.02305. ANELLO

2 — 590.20188
DISCO COMPL.

590.02304 DISCO *

561.02770 DISCO *

563.20170 FONDELLO — 1

3 — 580.02306 MOLLA

590.02426 MANICOTTO CON DISCO — 4
CAGE 310.1/



Od štev. 1
do štev. 6

TAV.

1

FRIZIONE
Sklopka
Kvačilo

622 - DIFF.
622 - INN.

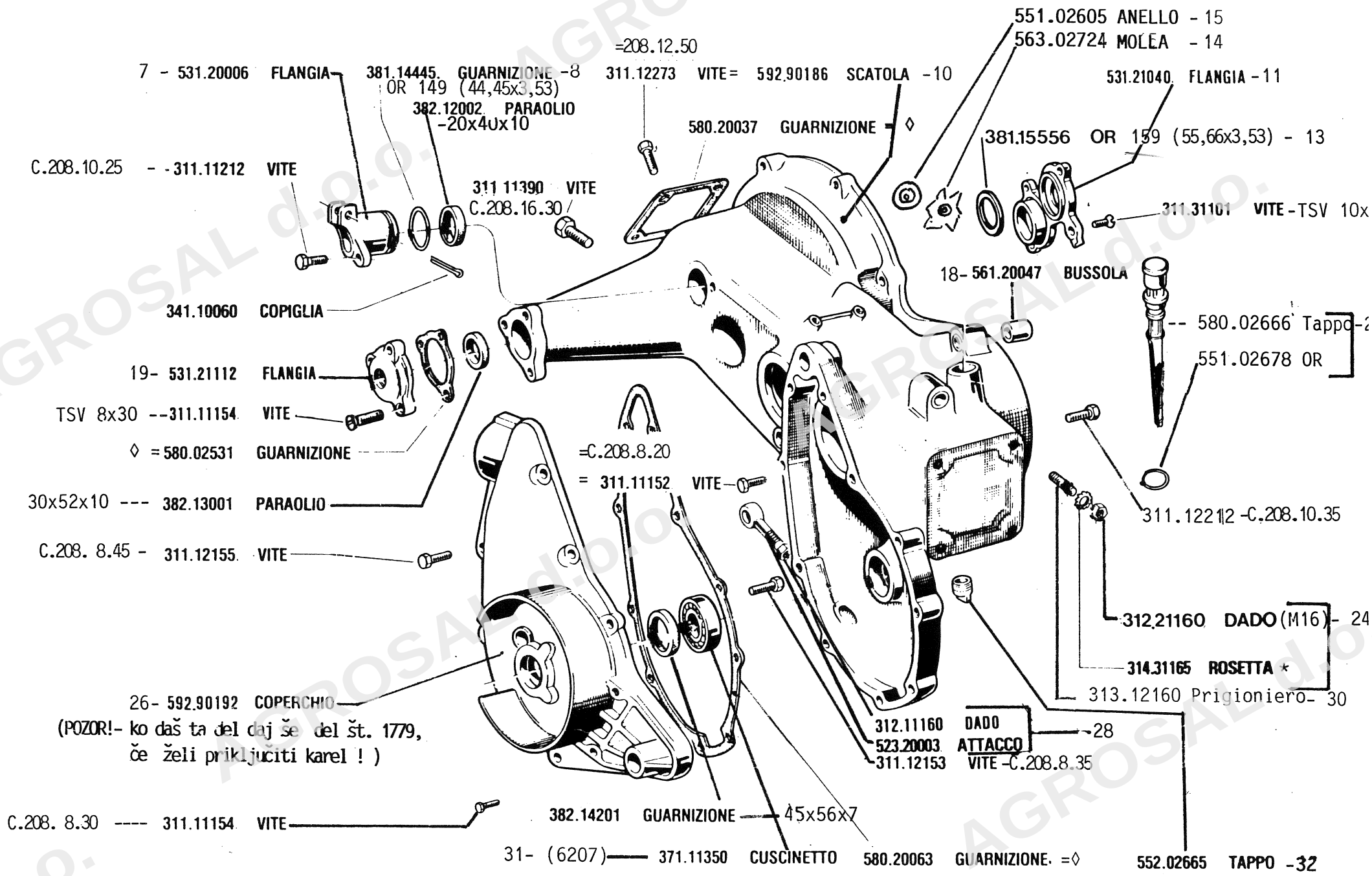

Od štev. 7
do štev. 32

TAV.

2

SCATOLA E COPERCHIO
Ohišje in pokrov

◇- 580.90082 KIT TESNIL -33

622 - DIFF.
622 - INN.

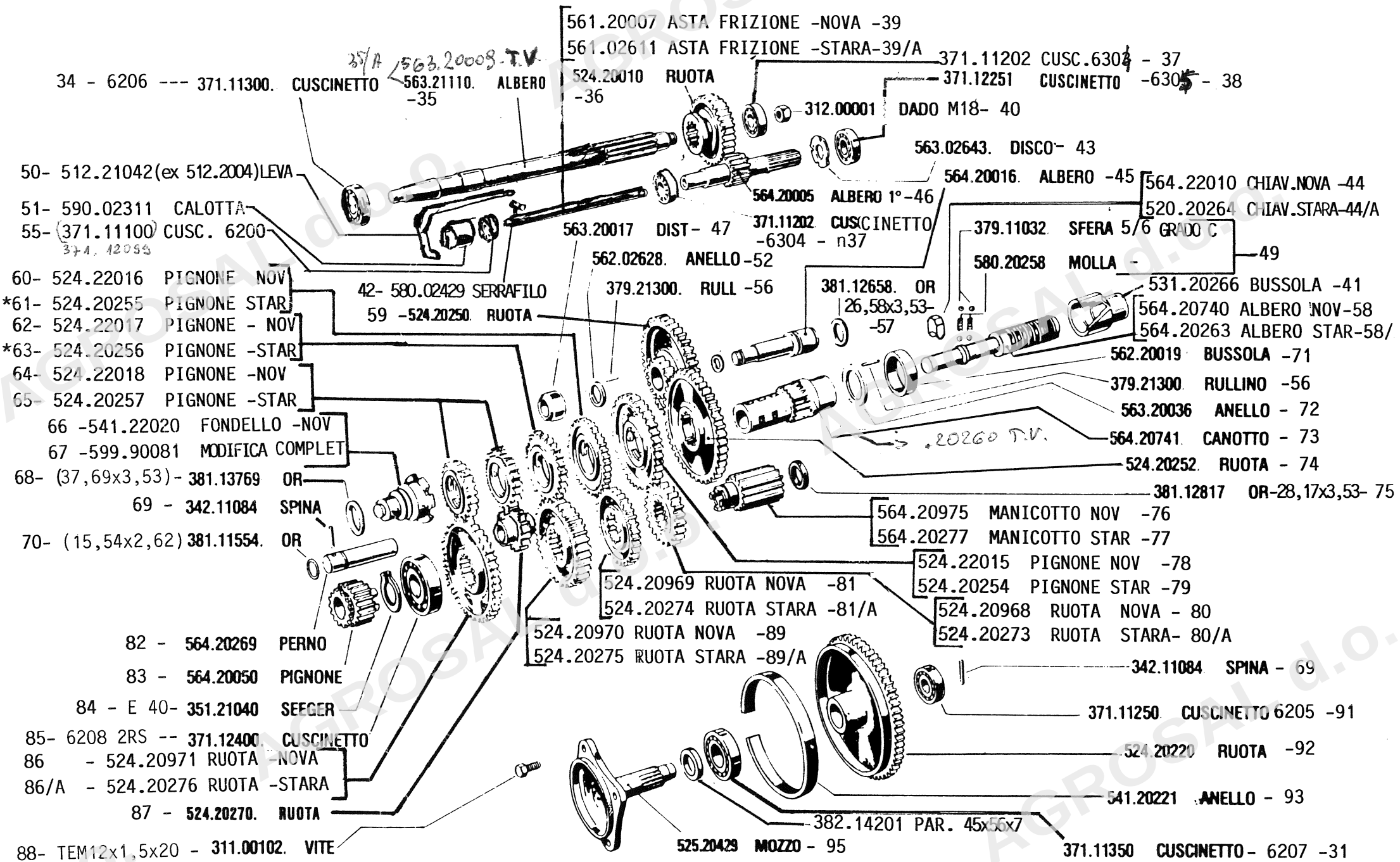

Od štev. 34
do štev. 95

TAV.

3

INGRANAGGI CAMBIO
Zobčeniški menjal
Zupčanik menjača

4

CON DIFERENZIALE= vse enako
brez delov števil: 75-76(77)
83- 84- 85-

622 - INN.

V. O. V. DHEKE VS'

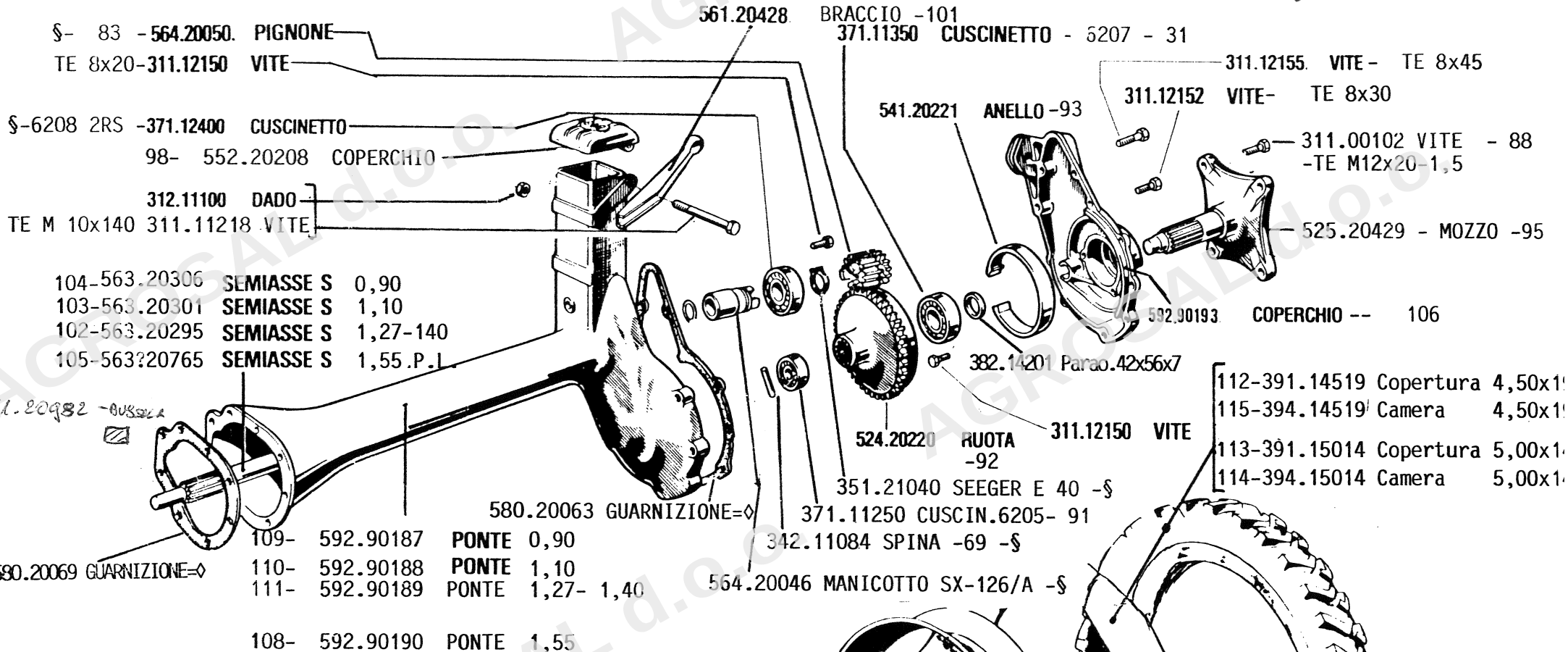

TAV

5 RAZLIČNI DELI:

| | | | |
|------|-----------|------------|---------|
| 121- | 563.20280 | SEMIASSE S | 127-140 |
| 122- | 563.20392 | SEMIASSE S | 110 |
| 123- | 563.20393 | SEMIASSE S | 0,90 |
| 124- | 563.20394 | SEMIASSE S | 155 |

DIFFERENZIALE in deli označeni z \$-

| | | |
|------|------------|-------------|
| 117- | 580.20234. | RUOTA 14" D |
| 120- | 590.20247 | RUOTA 14"S |
| 119- | 590.20246 | RUOTA 19" S |
| 118- | 580.20233 | RUOTA 19"D |

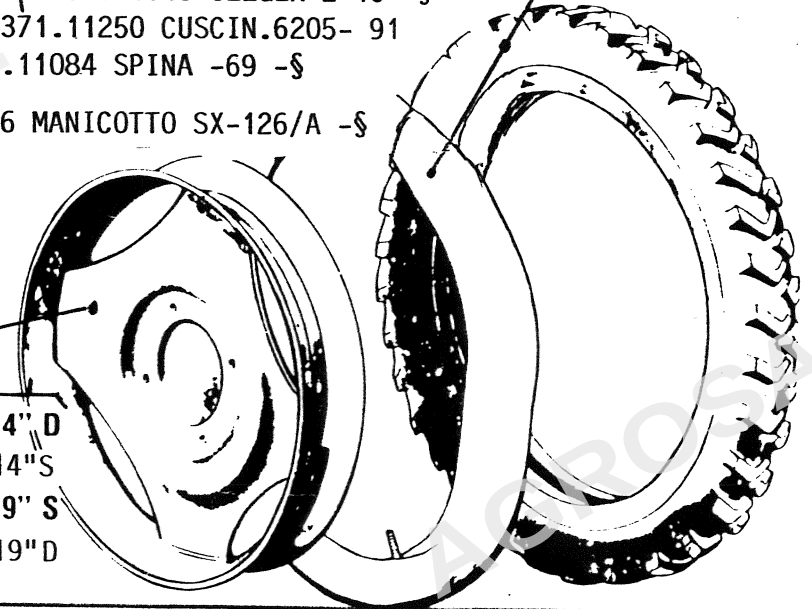

Od štev. 97
do štev. 126

TAV.

6

Ponte e ruote
Most in kolesa
Most i točkovi

622 - INN

5-82 015

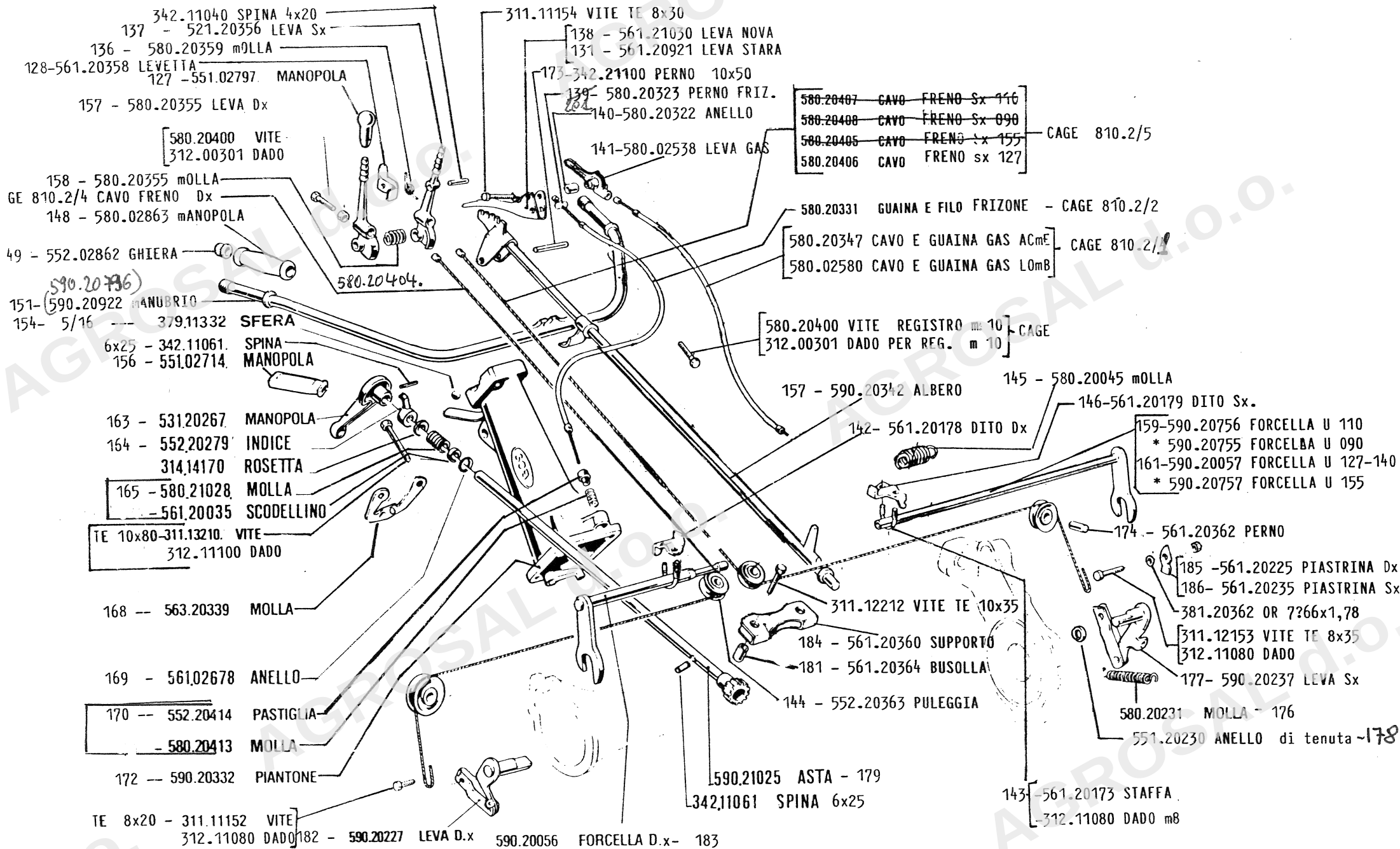

Od štev. 127
 do štev. 186

TAV.

7

MANUBRIO E COMANDI
 Držaj in vzvodi
 Bilanca i komande

NON DIFERENZI

622 - INN.

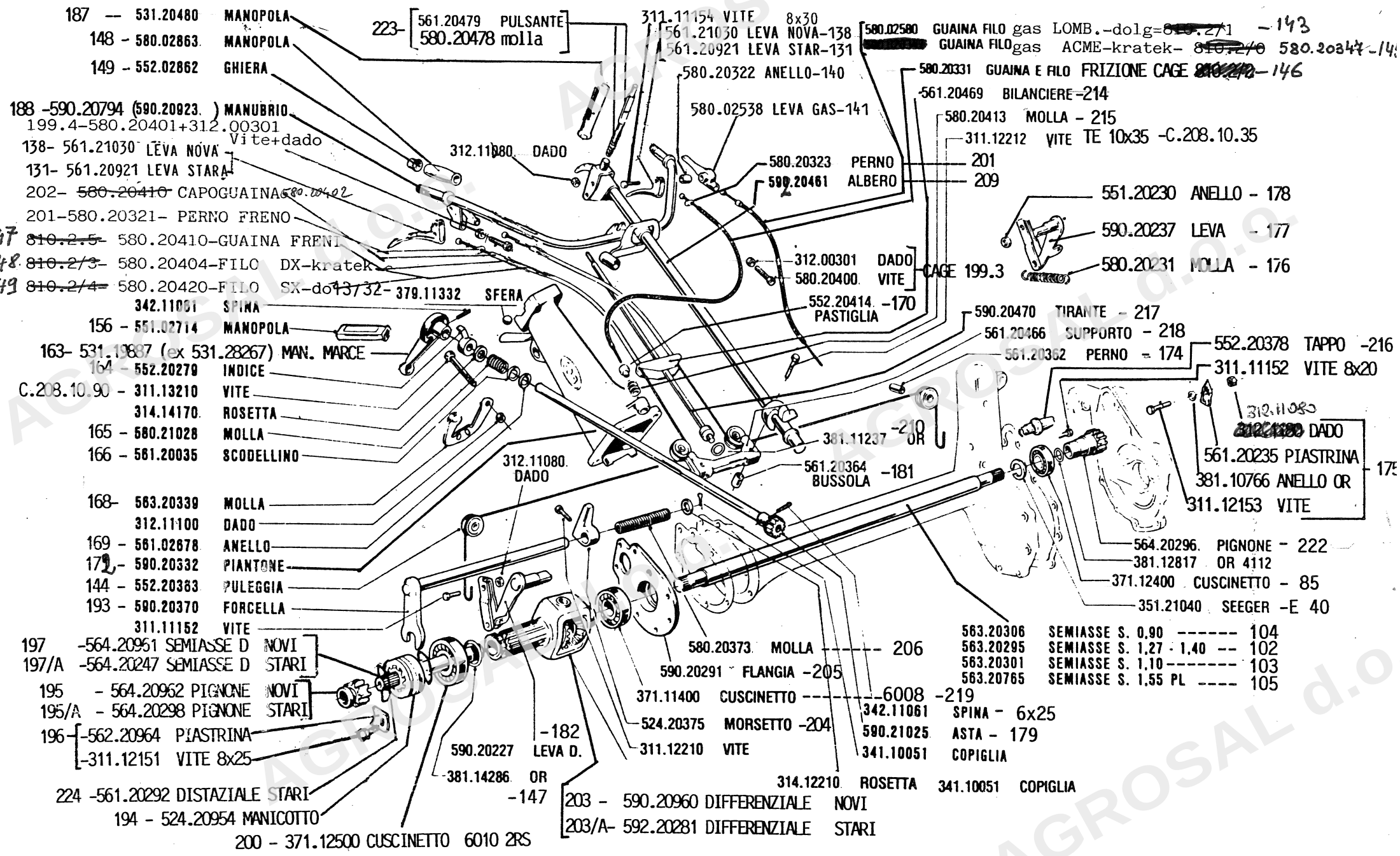

Od štev. 187
do štev. 224

TAV.

8

Manubrio e comandi
Držaj in vzvodi
Bilancia i komande

622 - DIFF.

5-82 - 016

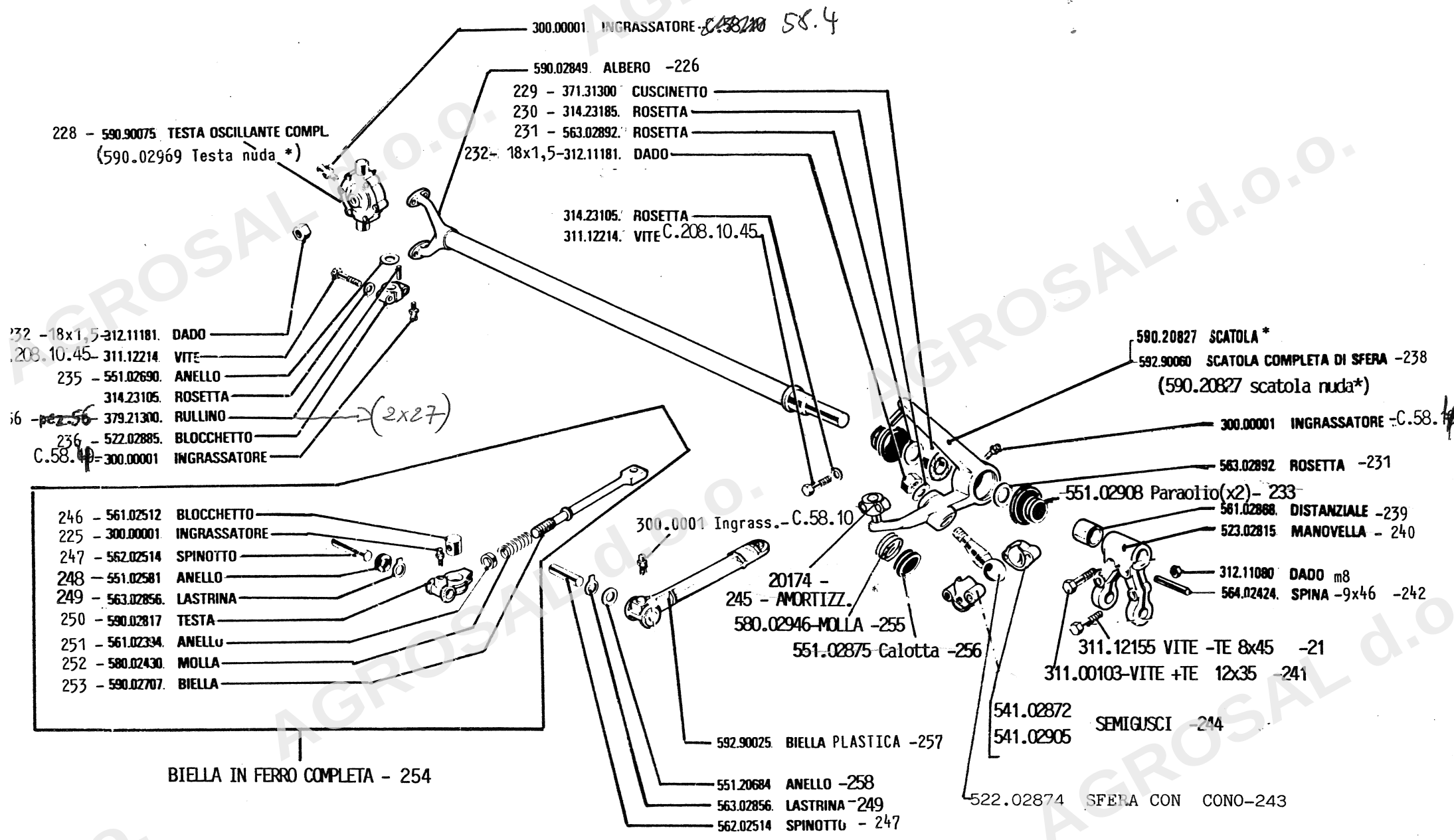

Od štev. 225
do štev. 258

TAV

9

ALBERO - SCATOLA OSCILLANTE
POGONSKA OS - NIHAJOČA GLAVA
POGONSKA POLUGA - TRZAJUČE KUČIŠTE

622 - DIFF.
622 - INN.

5-82-012

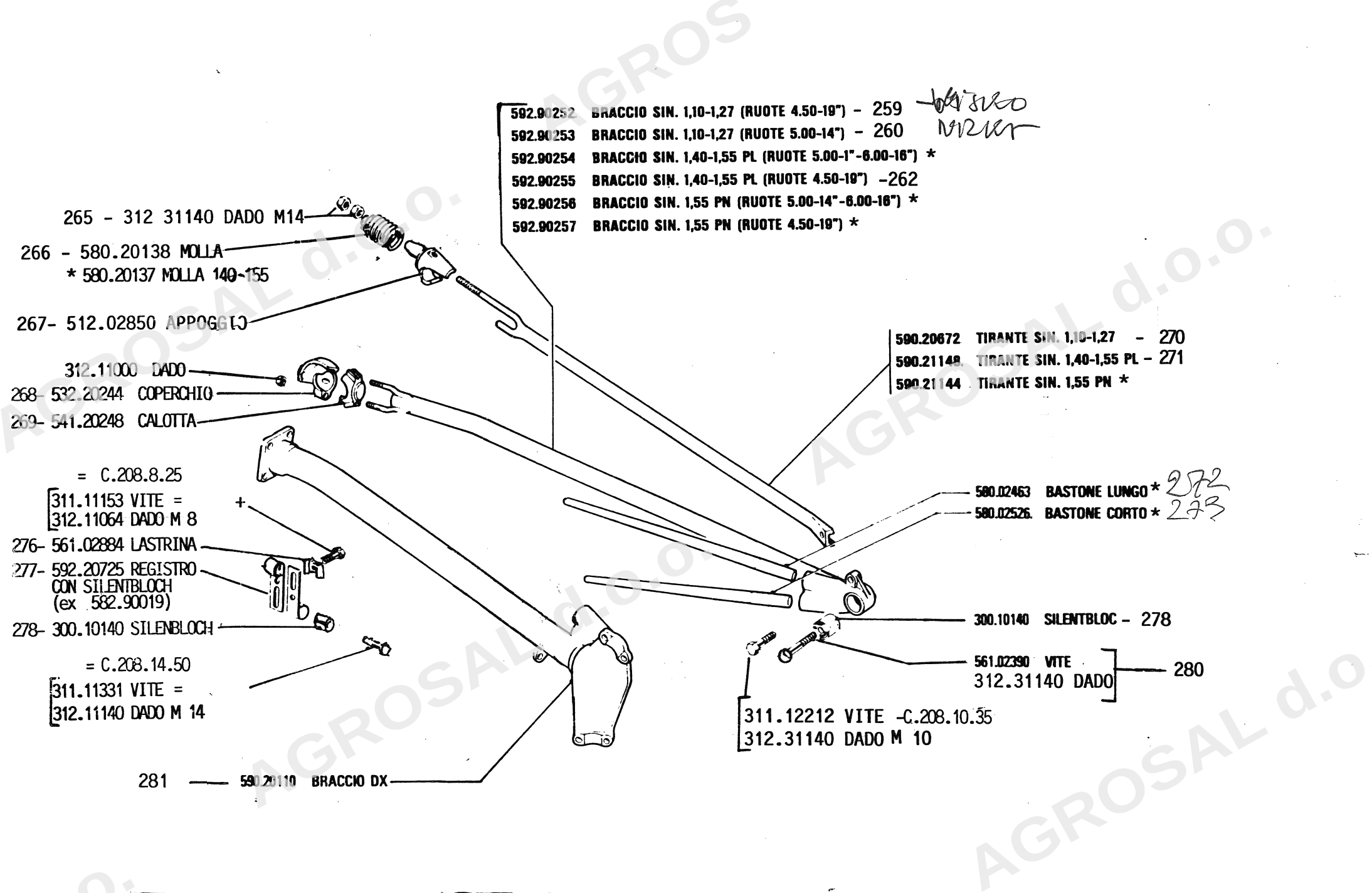

Od štev. 259
do štev. 281

TAV.

10

BRACCI
Nöşilci
ŞTAPIÇI

622 - DIFF.
622 - INN.

1-84 - 006

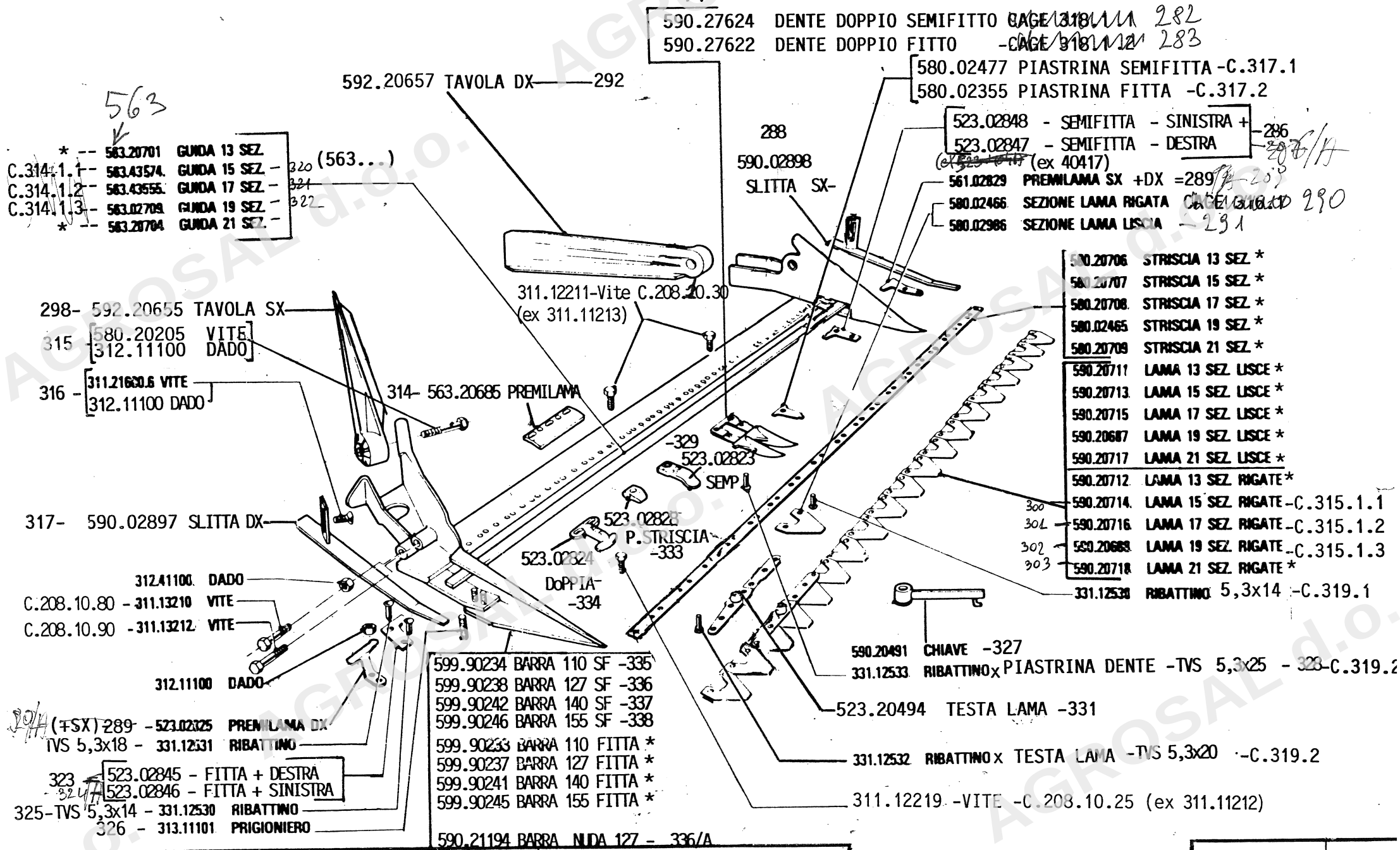

Od štev. 282
do štev. 338

TAV.
TABLE
TABLA
TAFFI

11

Barra
Greiben
Kosioni uredaj

334/A KIT PREMILAMA :
523.02824 (doppio) pezzi 1 +
523.02823 (semplice) -" - 3

622 - DIFF.
622 - INN.

1-84 - 007

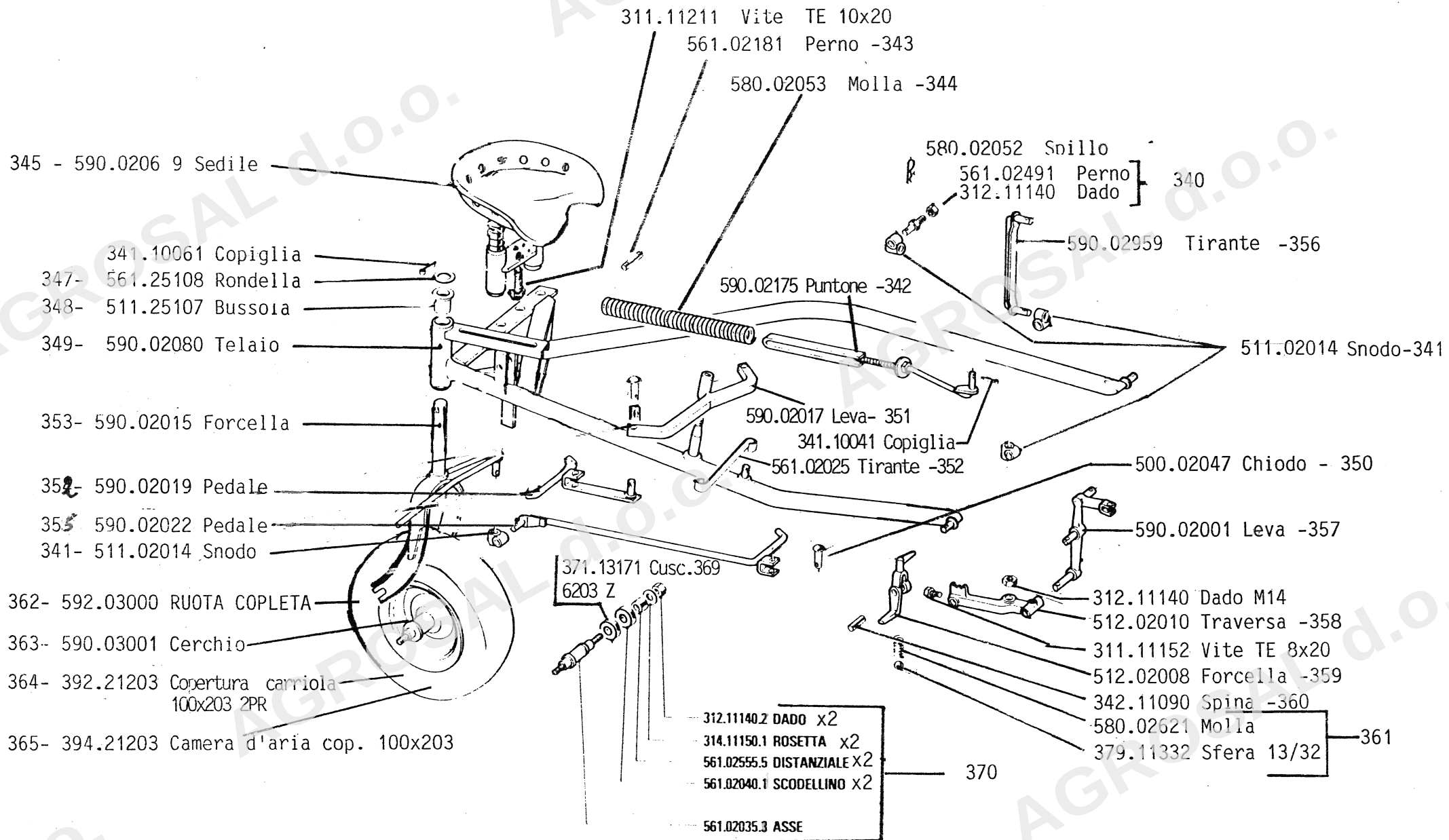

Od štev. 339
 do štev. 370

TAV.

12

CARRELLO
 Sedež
 Kolica

622 - DIFF.
 622 - INN.

5-82-008

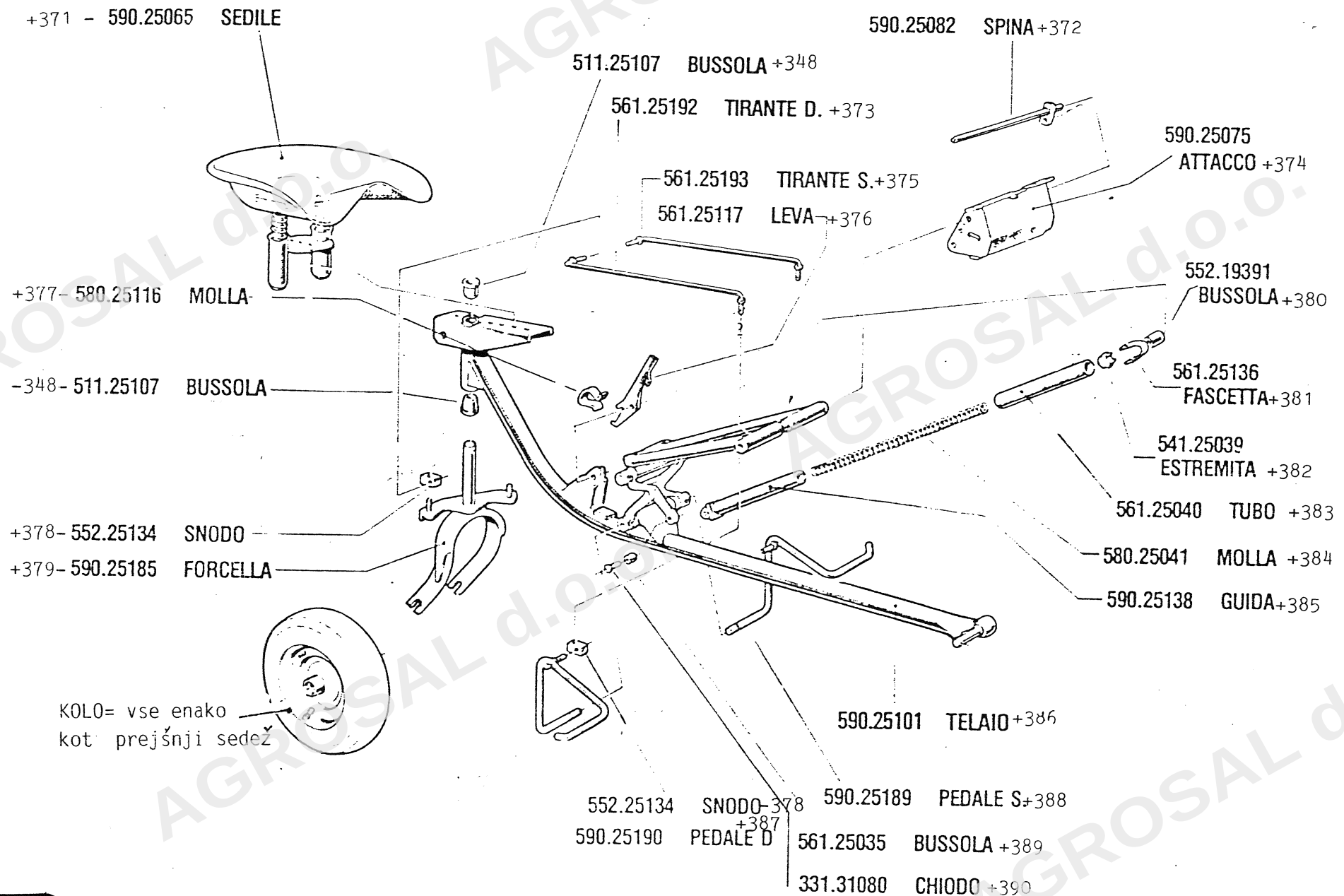

DAL N. 371
 AL N. 390

Carello
 Sedež
 Kolica

TAV.

13

622 - DIFFERENZIALE
 622 - INN. ESTI

5.82 - 000

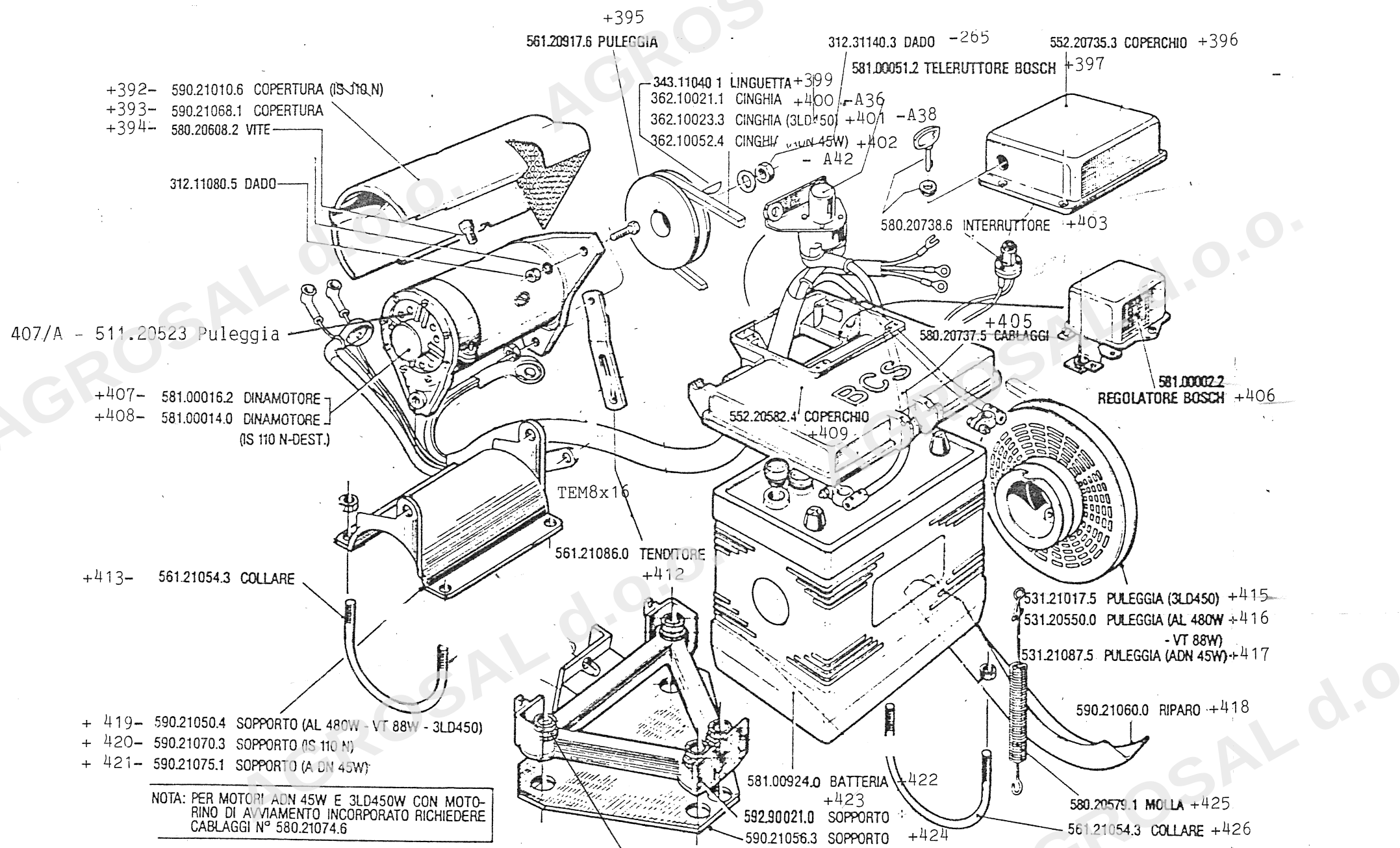

NOTA: PER MOTORI ADN 45W E 3LD450W CON MOTORINO DI AVVIAMENTO INCORPORATO RICHIEDERE CABLAGGI N° 580.21074.6

DAL N. 391
 AL N. 427

| | | |
|------|-----------|---------------------|
| TAV. | 15 | 622 - DIFFERENZIALE |
| | | 622 - INN. ESTI |
| | | 5-82 - 010 |

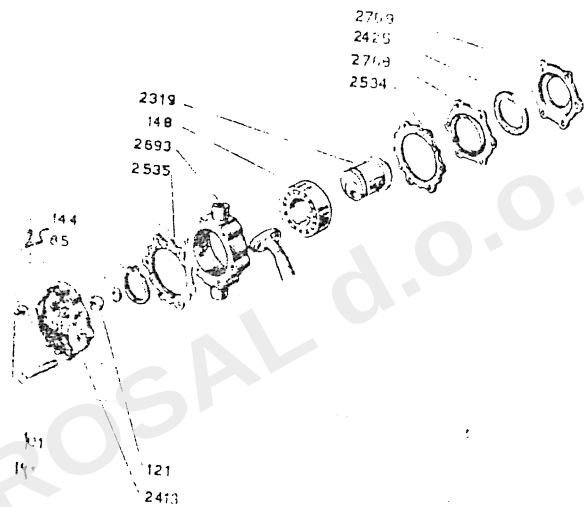

--580.02777 Ganasce t.veccchio - 440



--58.02772 Molla ganasce t.veccchio-441

| | | | |
|------|-------------|-----------------------|-----|
| 101 | 311.31062 | Vite TSV MA 6x55 | 430 |
| 144 | | Seeger E 55 | |
| 148 | | Cuscinetto | 431 |
| 2319 | 511.02319.2 | Blocco inclinato | 432 |
| 2413 | 531.02413.0 | Calotta | 433 |
| 2425 | 551.02425.0 | Anello + | |
| 2534 | 580.02534.2 | Guarnizione | 435 |
| 2693 | | Anello per cuscinetto | 436 |
| 2768 | | 1° Flangia | 437 |
| 2769 | | 2° Flangia | 438 |